

My50 E/B



Low Price, High Quality.  
We reduced the product price.  
But, we did not renounce to quality!

 **FIMAP**<sup>®</sup>

## Available equipment:

STANDARD EQUIPMENT	My50 E	My50 B
<b>Water and detergent management</b>		
FSS (Fimap Solution Saver)	•	•
Eco On/OFF System* - Water filter	optional	optional
Fast water filling with drip stop	•	•
Water level indicator	•	•
<b>Scrubbing performance</b>		
Squeegee with polyurethane rubber bars usable on 4 sides	•	•
Cleaning along walls (right side with 55 cm brush)	•	•
<b>Operating autonomy</b>		
12 V/102 Ah C20 (2) batteries	-	optional
12V/75 Ah C20 (2) gel batteries	-	optional
12 V/120 Ah C20 (2) batteries	-	optional

STANDARD EQUIPMENT	My50 E	My50 B
<b>Comfort</b>		
FNC (FimapNoiseCanceling)	•	•
Fully sanitizable tanks	•	•
Intuitive drive system (ID-Intelligent Drive)	•	•
On-board battery charger	-	optional
Hour meter	•	•
Battery warning light	-	•
Battery charge level	-	•
Automatic brush coupling and uncoupling	•	•
<b>Safety</b>		
Non-marking wheels	•	•
Squeegee with shock-resistant coupling (BREAK AWAY)	•	•
Dead man's switch	•	•

\* Eco ON/OFF system: automatically stops water flow when the machine is stationary.



# My50 E/B scrubbing machine.

**AFFORDABLE,**

**because it does not need skilled operators for driving!**



**USER FRIENDLY DESIGN**

No operator training

You can start working with just 3 quick and simple operations!

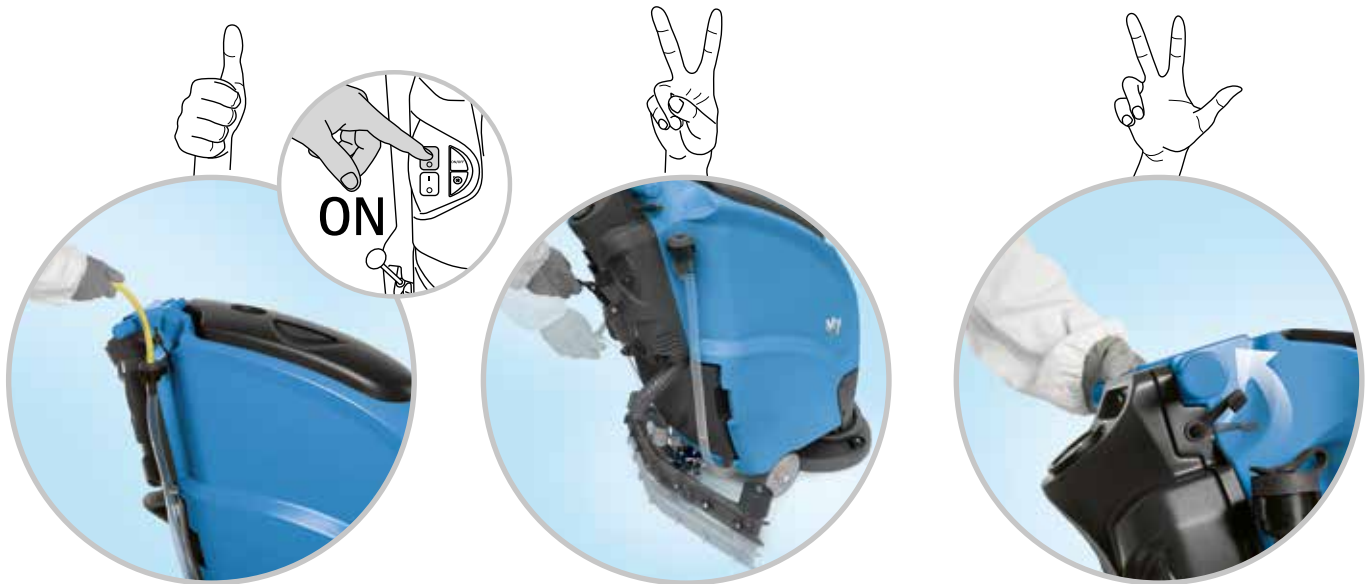

Fill in the solution tank and  
switch on the machine!

Lower  
the squeegee...

... and start to work!

## My50 E/B scrubbing machine.

**AFFORDABLE, because it offers more autonomy.**



Autonomy up to 3 hours with 1 full charge



Non-stop work up to 1 hour and 2.000 sq.m  
with 1 fill of solution



The FSS (Fimap Solution Saver) system allow to adjust water consumption according to cleaning needs

## My50 E/B scrubbing machine.

**AFFORDABLE,  
thanks to the new squeegee in reinforced plastic.**



**It is safer, because more resistant to impacts and corrosion.**

Automatic squeegee\* uncoupling when accidentally impacted

**BREAK AWAY**

\* PATENT PENDING

## My50 E/B scrubbing machine.



**AFFORDABLE,**

**because it is simple in maintenance operations!**

**It can be easily cleaned at the end of cleaning operation, even by untrained operators.  
It is quick to be cleaned!**

The easy identification of the parts involved in the daily maintenance (with yellow colour) ensures all parts' check and sanitification at the end of work, guaranteeing the maximum efficiency of the machine

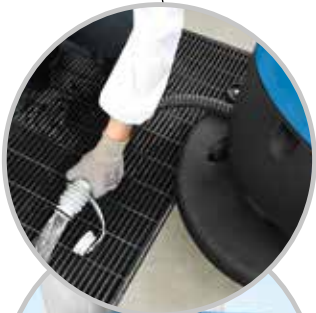

Empty and sanitize...



Clean the filter!











Clean the squeegee!



... recharge!  
(Battery version)

An on-board charger option makes battery re-charging safe and easy (on request)

TECHNICAL DATA		My50 E	My50 B
Squeegee width	mm	680-780	680-780
Disc brushes Ø	(n.) mm	(1) 510 - 530 - 550	(1) 510 - 530 - 550
Brush motor	V/W	220-230/750	24/560
Brush rpm	rpm	135	135
Brush pressure	kg	27,5	27,5
Suction motor	V/W	230/450	24/310
Type of drive	-	semi aut.	semi aut.
Battery compartment dimensions (L x h x w)	mm	-	330 x 345 x 270
Max gradient at full load	%	2%	2%
Batteries	V/Ah C5	-	12 V/90 Ah
Batteries weight	kg	-	54
Machine weight (without battery)	Kg	62	62

	 Electromagnetic compatibility Emission standard	 Working width cm	 Number of brushes	 Supply V/ traction	 Solution tank l	 Recovery tank l	 Working capacity up to sq.m/h	 Machine dimensions in mm L x h x w
My50 E	EN 61000-6-2, 3	51-53-55	1	230/50 /semi aut.	40	40	1600	1165x995x541
My50 B	EN 61000-3-2, 3			- /24/semi aut.				



Saves up to 50% on water and detergent



Reduction of energy consumptions to increase working autonomy



Operate in environments without noise disturbance



New training free intuitive driving system



24 months extended warranty



Fimap Certified Quality

For any additional information or for a demo please contact your usual Fimap dealer

Dealer's stamp



Fimap Spa reserves the right, at anytime, to make technical and/or equipment modifications without prior notification. The images are shown as reference only and are not binding as to the actual design and/or equipment - Copyright © Fimap 2010 COD. 301721 - AE - 03-2019

[www.fimap.com](http://www.fimap.com)

An ISO 9001:2015, ISO 14001:2015,  
OHSAS 18001:2007  
Organisation certified by Q.C.B. Italy

FIMAP spa - Via Invaldi del Lavoro, 1 - 37059 S. Maria di Zevio - Verona - Italy  
Tel. +39 045 6060411 - Fax +39 045 6060417 - E-mail: [fimap@fimap.com](mailto:fimap@fimap.com)

